

LUXPRO®

PSPHA732



PSPHA732

Up to 3 Stage Heat / 2 Stage Cool

7 DAY PROGRAMMABLE THERMOSTAT with AUTOCHANGEOVER

- **Autochangeover**
- **Fully Programmable IAQ Clean Cycle™ (Patent Pending) Intermittent Fan**
- **Programmable Auto Changeover Dead-Band (1°F to 6°F)**
- **7 Day Programming - 4 Periods Per Day**
- **Easy Programming with Lux Speed Dial®**
- **Dual Power - System or Battery Powered with Battery Free Memory Storage**
- **Emergency and Auxiliary Heat Indicators**
- **Programmable Filter Timer with Change Filter Indicator**
- **Temporary Override is CAT24 Compliant**
- **Vacation Override**
- **Adjustable 2 or 5 Minute A/C Compressor Delay**
- **Energy Usage Monitor**
- **EL (Electro Luminescent) Back Light Display**
- **Mode and Fan Slide Switch**
- **Optional Early Recovery**
- **Energy Star Compliant**
- **Batteries Included**
- **1-Year Warranty**
- **F/C Selectable**
- **12/24 Hr Clock**
- **Temperature Calibration**
- **Multi-Stage Adjustable Temperature Differential/Cycle Rate (.25 - 2.25)**
- **Programming Copy Button**
- **Keyboard Lockout**
- **Speed Dial® Reprogramming**
- **High Efficiency Systems**
- **Contractor Grade**
- **On-Screen Low Battery Indicator**
- **Soft Touch Buttons**
- **Default Energy Star Approved Program**
- **Separate Temperature for Heating & Cooling**
- **Hold Constant Temperature Override**
- **Audible Keypad Entry Response**
- **1 Minute Optional Residual Fan**

COMPATIBLE WITH:

- Heat Pump up to 2 Stage Heat and 2 Stages of Cooling PLUS Auxiliary Heat and Emergency Heat
- Low Voltage (24 Volt) Systems
- Single Stage Heat Pump

NOT COMPATIBLE WITH:

- 3 Wire Hydronic System
- Line Voltage System (without transformer)

LUX PRODUCTS CORPORATION

6000 I Commerce Parkway • Mt. Laurel, NJ 08054 • (856) 234-7905 • FAX (856) 234-7825 • www.luxproproducts.com

LUXPRO[®]

PSPA732

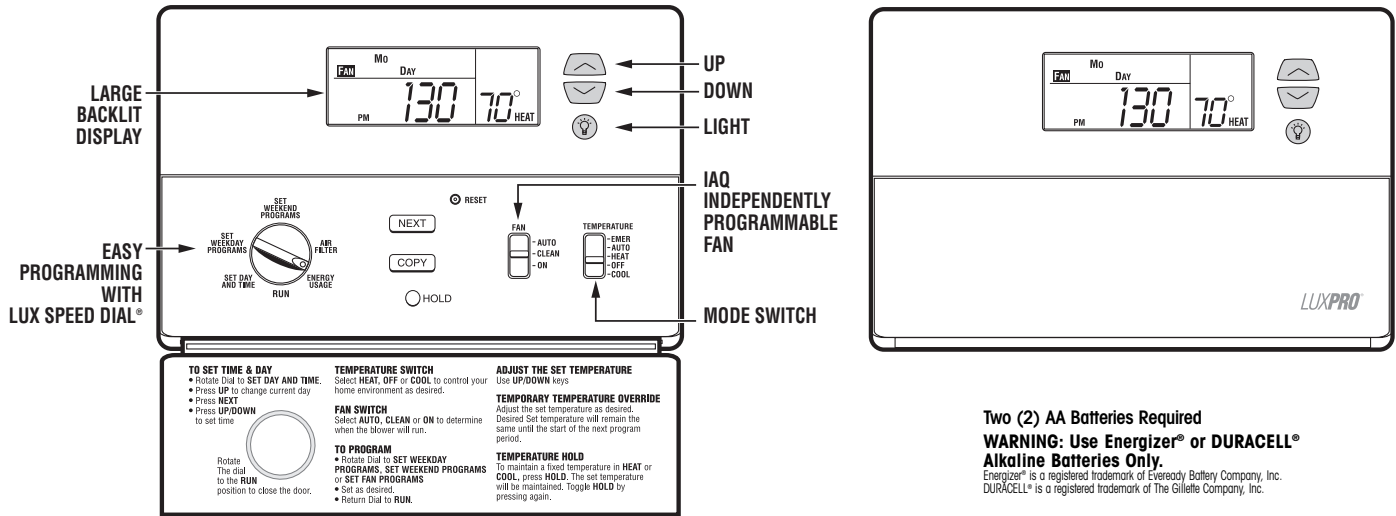

GENERAL DESCRIPTION:

5.90" (150mm) wide x 4.13" (105mm) tall x 1.18" (30mm) deep

Wall plate: 6.5" (165mm) x 4.33" (110mm)

Description: Digital Thermostat offers programmable control of up to 3 Stage Heat / 2 Stage Cool heating and cooling systems. Temperature control adjustable.

SPECIFICATIONS:

Heat/Cool Terminals: R, O, B, Y1, Y2, W1, G, C, E.

Electrical Ratings: 1½ AMPS at each terminal, 2 AMPS total 24v AC. System or Battery Powered: 2 "AA" Batteries .

Temperature Control Range: 45°F to 90°F (7° to 32°C). Accuracy: ±1°F over a range of 50°F to 95°F.

Environmental Limits:

Moisture and Dust: meets IP20.

Operating Humidity: 20% to 90% non-condensing.

Operating Temperature: +32°F to +122°F (+0°C to +50°C).

Storage Temperature: -4°F to +140°F (-20°C to +60°C).

Electrical Immunity: meets relevant CE specifications.

WARNING: Use Energizer[®] or DURACELL[®] Alkaline Batteries Only.

Energizer[®] is a registered trademark of Eveready Battery Company, Inc. - DURACELL[®] is a registered trademark of The Gillette Company, Inc.



LUX Products Corporation 6000 I Commerce Parkway • Mt. Laurel, NJ 08054
 (856) 234-7905 • FAX (856) 234-7825 • www.luxproproducts.com

JOB NAME: _____ DATE: _____

CONTRACTOR: _____ UNIT DESIGNATION: _____

ENGINEER: _____ MODEL NO.: _____

SUBMITTED FOR: APPROVAL RECORD LOCATION: _____